

FAST

2,3 m



Quick to install automation

FAST is the new articulated transmission arm automation for gates with wings up to 2,3 m for each wing. A new product, which measures up to precise application demands: it can be installed on to relatively small posts and columns (from 20 cm (8")), and is particularly recommended for gates with distances of up to 20 cm (8") between the gate hinge and the edge of the column.



Total functionality in a compact form

- **Practical and safe** manual mechanism to release the gate in the absence of electricity; the device is also protected by a door locked with a personalised key.
- To further simplify the release operation, the device may also be integrated with a wire release system and accompanying safety box.
- All versions are also equipped with an electromechanical gearbox with **permanent, fluid grease lubrication** and a **weatherproof**, articulated transmission arm.
- **For special space needs**, FAST may be installed with an upright transmission arm, thereby nullifying any lateral impediment caused by lifting of the transmission during movement.

FAST is available in the convenient SET COMPLETE confection, for the automation of gates with 2 wings.

Electronics to size and simplification of the connections

Choosing an automation from the FAST series, with incorporated control panel, means assurance that the product is easy to install, where all of the installation operations and electrical connections have been simplified (F7000). Alternately, choosing an application outside of the control panel, you can select from among numerous electronic solutions according to the demands of the user.



Simplicity and safety in continual circuitry

In the 24V version, thanks to the ZL170 control panel, for single wing gates, a **tri-polar cable** connection is sufficient for motor power and for directing the deceleration and stopping.

Available Models

- F 7000** 230V operator complete with articulated arm and incorporated control panel
- F 7001** 230V operator complete with articulated arm.
- F 7024** 24V operator complete with articulated arm



Technical characteristics

Technical information

Type	F7000	F7001	F7024
Protection level	IP54 (NEMA3)		
Power supply	230V (110V) A.C.		
Motor power supply	230V (110V) A.C.	230V (110V) A.C.	24V D.C.
Capacity	160 W	160 W	140 W
Duty cycle	30%	30%	intensive oper.
Max torque	180 N•m	180 N•m	180 N•m
Motor thermal protection	150 °C	150 °C	
Opening time (90°)	18S	18S	from 16 to 45S
Operating temperature	-20°C min. +70°C max.		

Use limits (1 Kg = 2,2 LBS - 1 m = 3,2 ft)

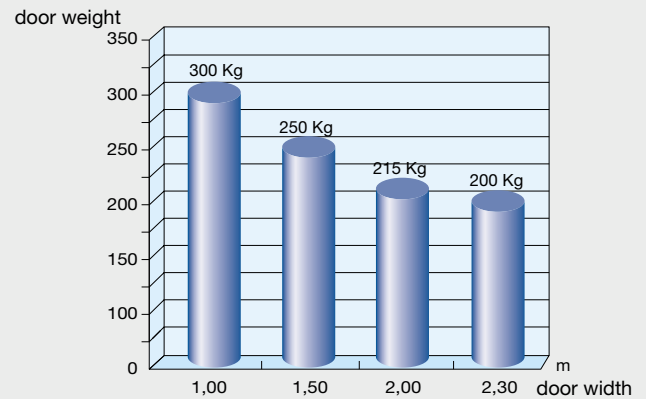

FAST can be applied to single doors up to 2,3 mt (7,5 ft) wide, with distances of up to 200 mm (8") between the hinge of the gate and the edge of the column.

Overall dimensions

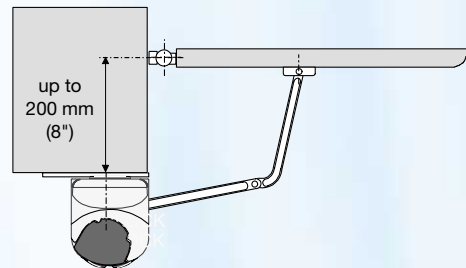
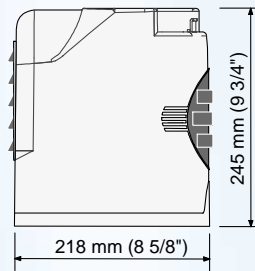
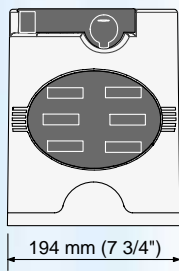

Swing gate system for industrial passage

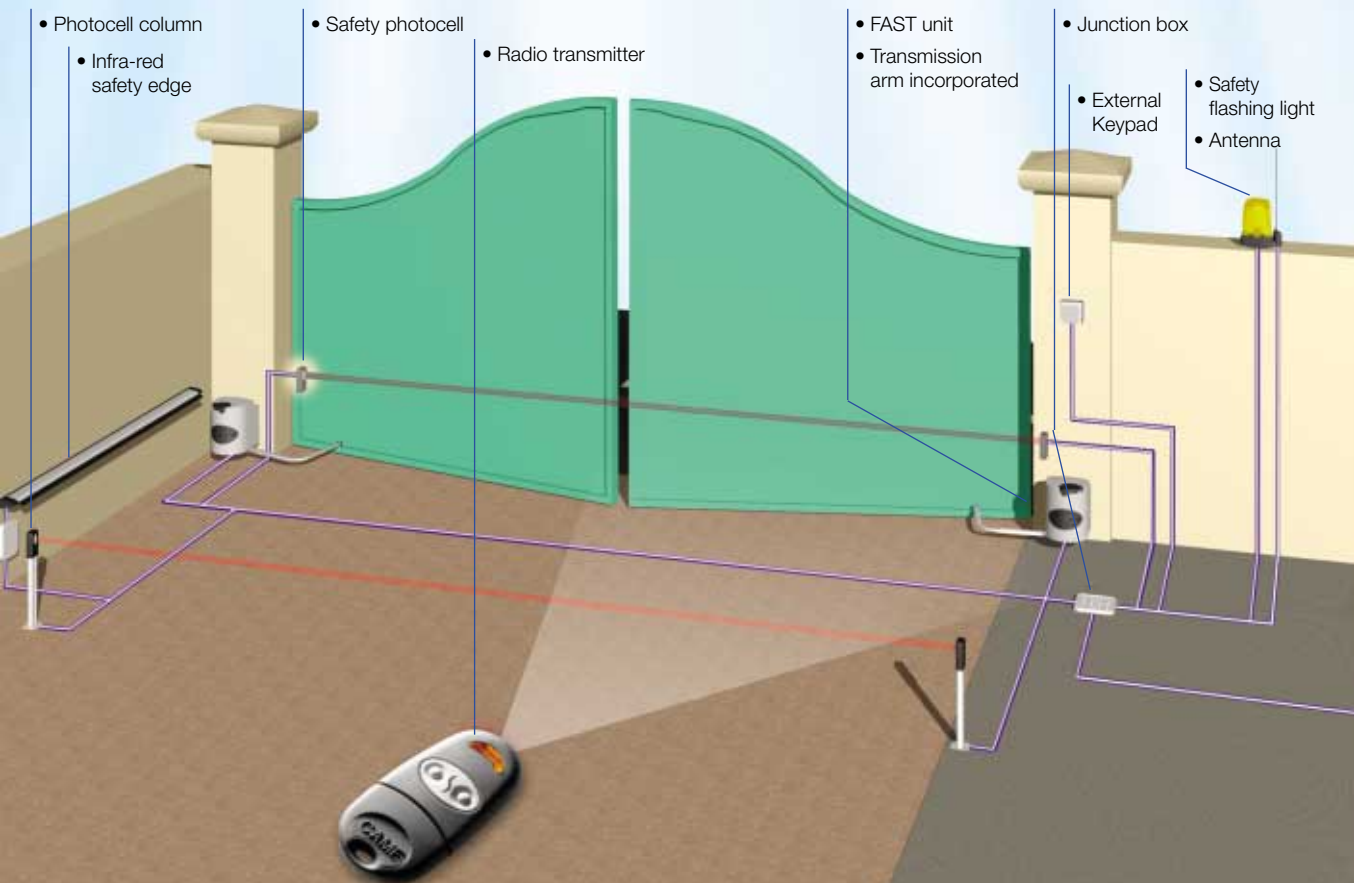

Applications